

BEST OF THAILAND



**BOOK
YOUR
SPOT
NOW**

ORCA DIVE CLUB
ONBOARD
THE ORCA OKTAVIA

**18TH TO 23RD
JANUARY, 2024**



*Karo **तो** jaano!*

ABOUT THE TRIP

WE BELIEVE THAT LIVEBOARDS ARE THE BEST WAY TO DIVE, AND THE BEST WAY TO REACH SOME OF THE TOP DIVE SITES IN THIS ROUTE

Similan Islands national marine park is widely recognized as the no. 1 SCUBA diving area in Thailand. From gentle sloping hard coral reefs to wild current swept rocky landscapes. The Western dive sites of the Similan Islands are mostly rocky and the East coast features sloping reefs. This variety makes the Similan Islands very popular.



Richelieu Rock is an isolated pinnacle horseshoe shaped consisting of several groups of rocks, pinnacles, overhangs and small caves. The marine life is bountiful. Small critters such as seahorses, ghost pipefish, harlequin shrimp, frogfish as well as big schools of trevally, barracuda, snappers and fusiliers... Ultimately, what we all hope to see is the giants of the ocean; Whale-shark's and Manta rays.

PROPOSED DIVE ROUTE

- **DAY 1 - SURIN 2 DIVES + RICHELIEU 2 DIVES**
- **DAY 2 - TACHAI 2 DIVES + BON 2 DIVES**
- **DAY 3 - SIMILAN 4 DIVES**
- **DAY 4 - SIMILAN 3 DIVES**

ABOUT THE BOAT

MV Orca Oktavia has 10 bedrooms with 4 Room types. All rooms come equipped with a private bathroom, AC, TV, Fridge, Dryer, hot water shower, etc and have large windows offering plenty of natural light with a wonderful view of the Andaman Sea and the Islands.

Cabin name : Whale Shark
Suite room
(Main Deck) 1 Room



Cabin name : Batfish, Jack Fish, Sea Turtle, Barracuda, Harlequin Shrimp
Twin Standard
(Main Deck) 5 Rooms



Cabin name : Manta Ray -
Deluxe Room (Upper Deck)
1 Room

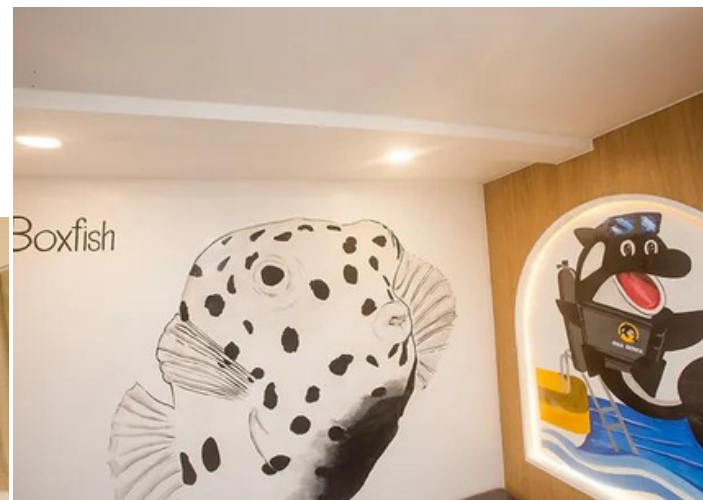

Cabin name :
Boxfish & Seahorse
Double Standard
(Upper Deck) 2 Room

Cabin name : Leopard Shark -
Deluxe Room (Main Deck)
1 Room



MORE ROOM PICS



BOAT FLOOR PLAN

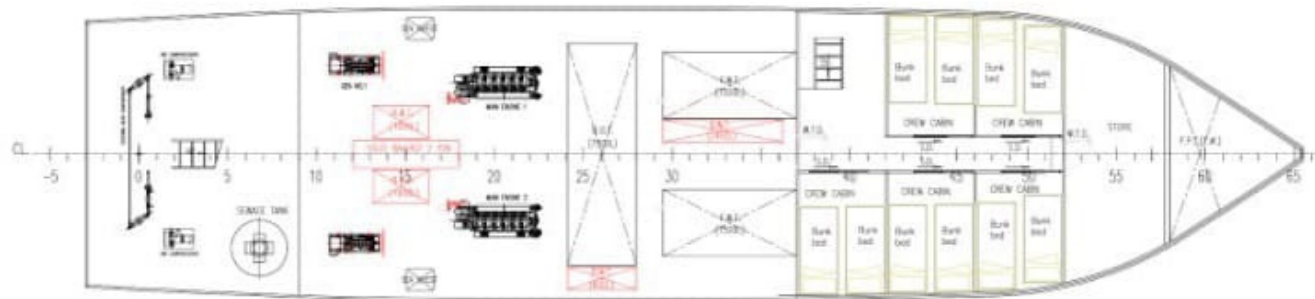

BOTTOM PLAN

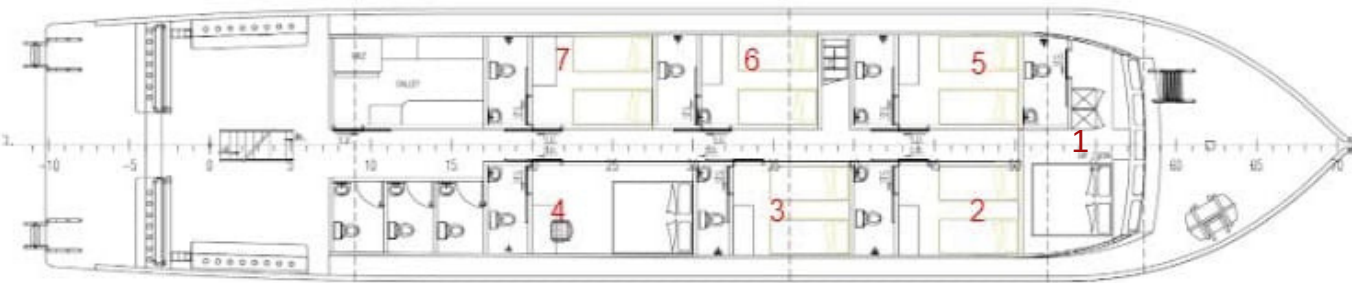

MAIN DECK

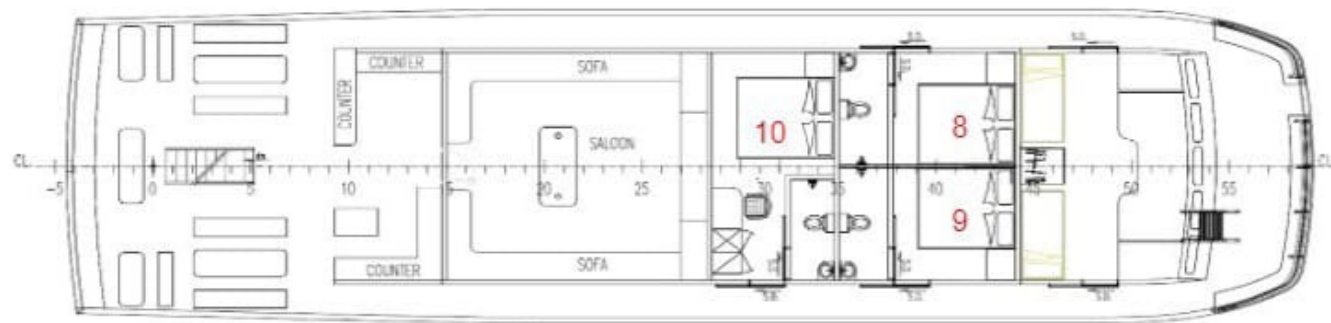

UPPER DECK

8	9
---	---

10

1

5	2
---	---

6	3
---	---

7	4
---	---

		
Std	Deluxe	Suite

COST / PERSON

Standard Twin/Double Cabin @ USD 965 pp ++

Deluxe Cabin @ USD 1040 pp ++

Suite @ USD 1120 pp ++

INCLUDES

- Full board meal
- Non Alcohol Beverages
- Snacks
- 3 -4 dives per diving day
- Tank 12L
- Scheduled Airport Transfer
- Orca Trip tshirt
- Trip after movie

EXCLUDES

- Flight + Visa
- 5% GST + TCS (as per latest govt rules)
- Staff Gratuity
- Taxes on payments made via credit card onboard
- Stay in Phuket before and after liveaboard dates
- National park fees @ THB 800 pp

ADDITIONALS

- Diving gears rental @ THB 400/day
- Nitrox @ THB 150/dive or THB 2000 for the trip
- Travel & Dive Insurance
- PADI Courses, if any
- 15L tanks

CANCELLATION

- 50% non refundable, if cancellation more than 2 months prior to trip
- No refund, if cancelled less than 2 months to trip departure

PAYMENT TERMS

- 50% to block your spot
- 50% 2 months prior to trip date (18th November, 2023)

